

We provide superior performing compressed air & gas systems with

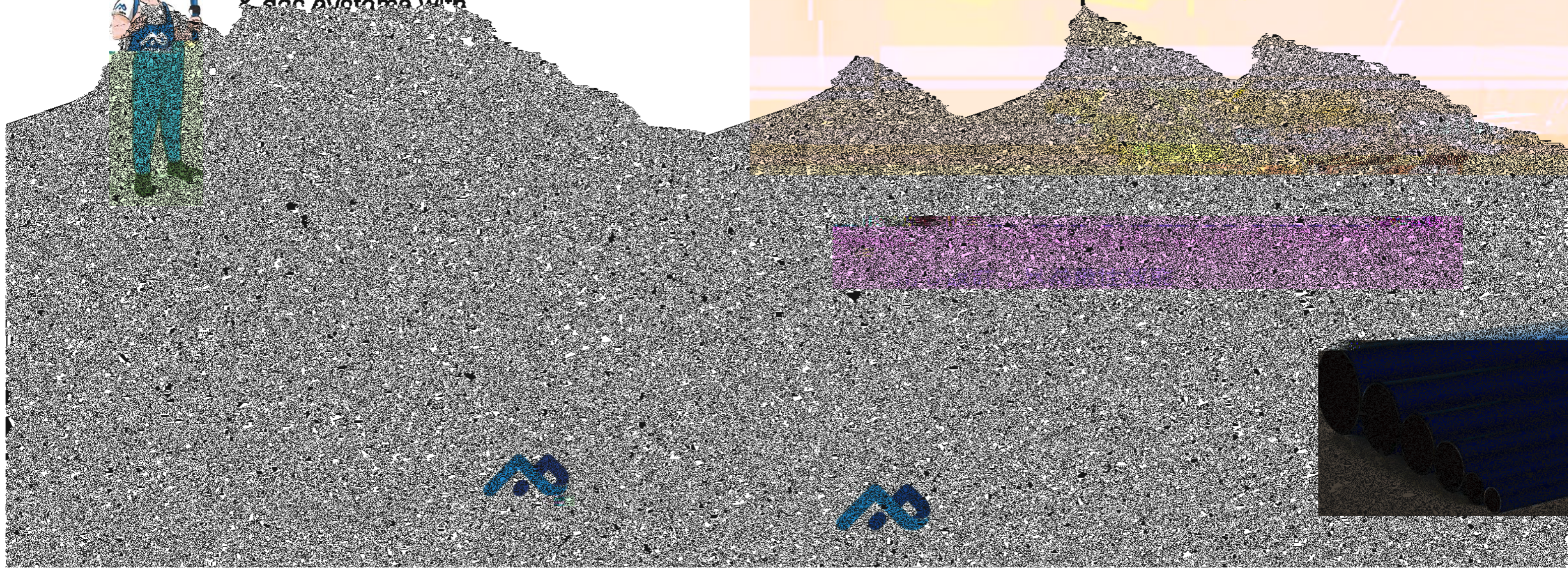

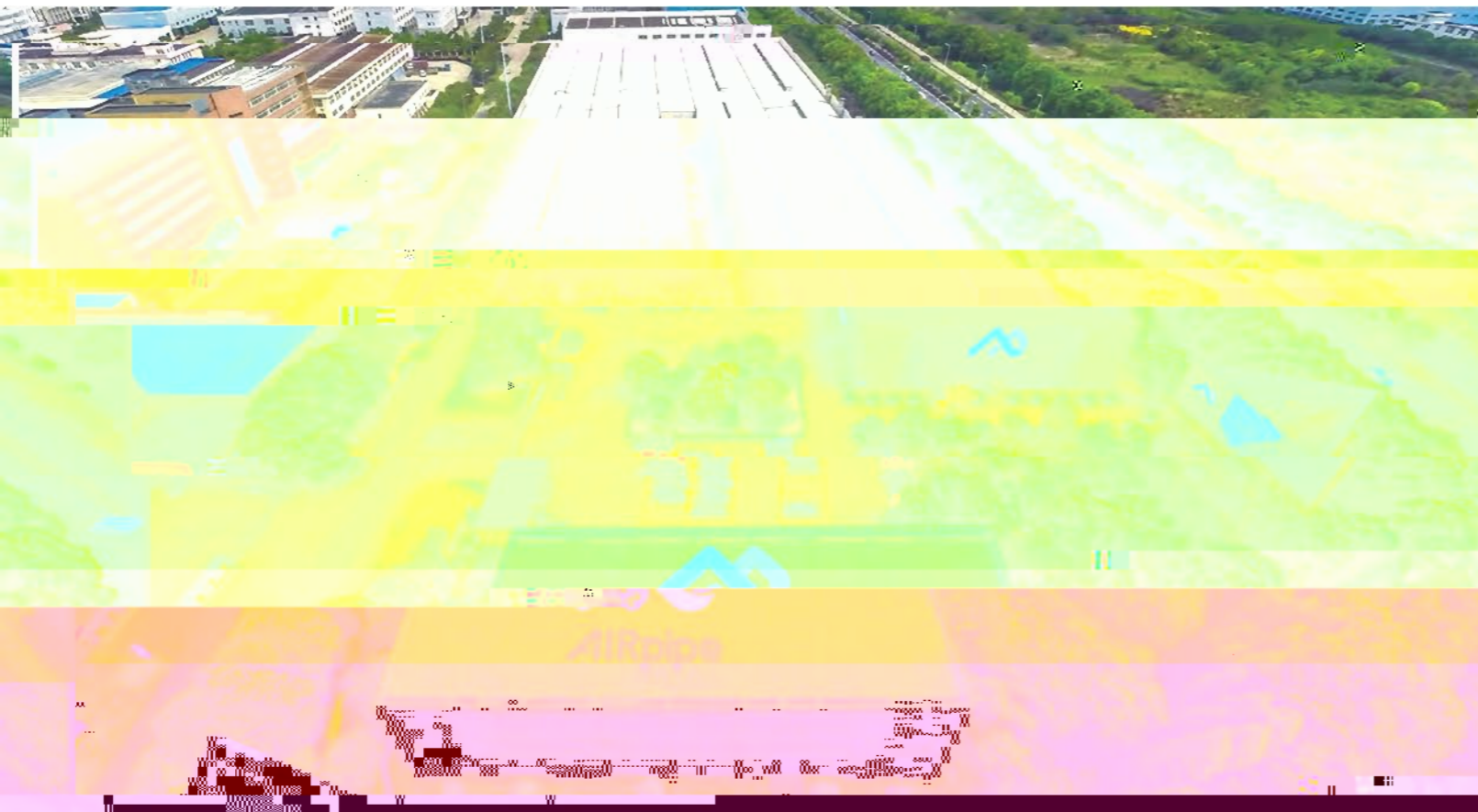

### Superior Reliability & Longevity 最佳可靠性和使用年限

- U
- M
- P
- B
- J
- K

### Quick & Easy Modular Installation 便捷的模組化安裝

- C
- R
- R
- Q
- S
- T

### Energy & Cost Savings 成本更效能節省最低使用成本

- T
- C
- J
- S

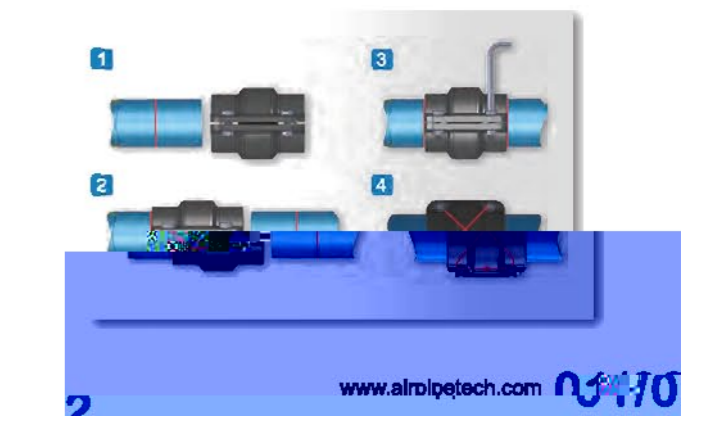
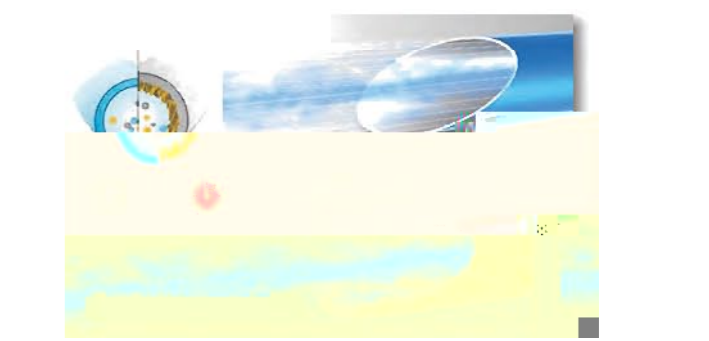
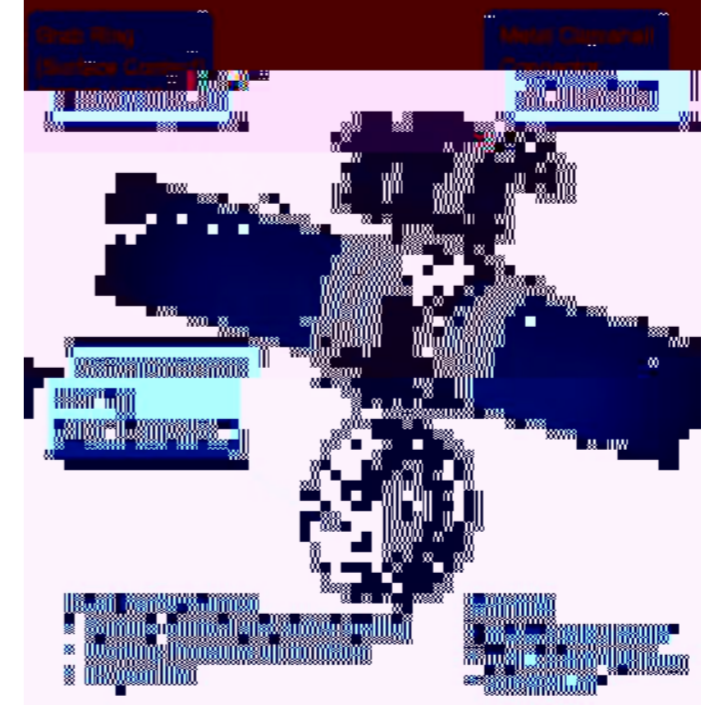

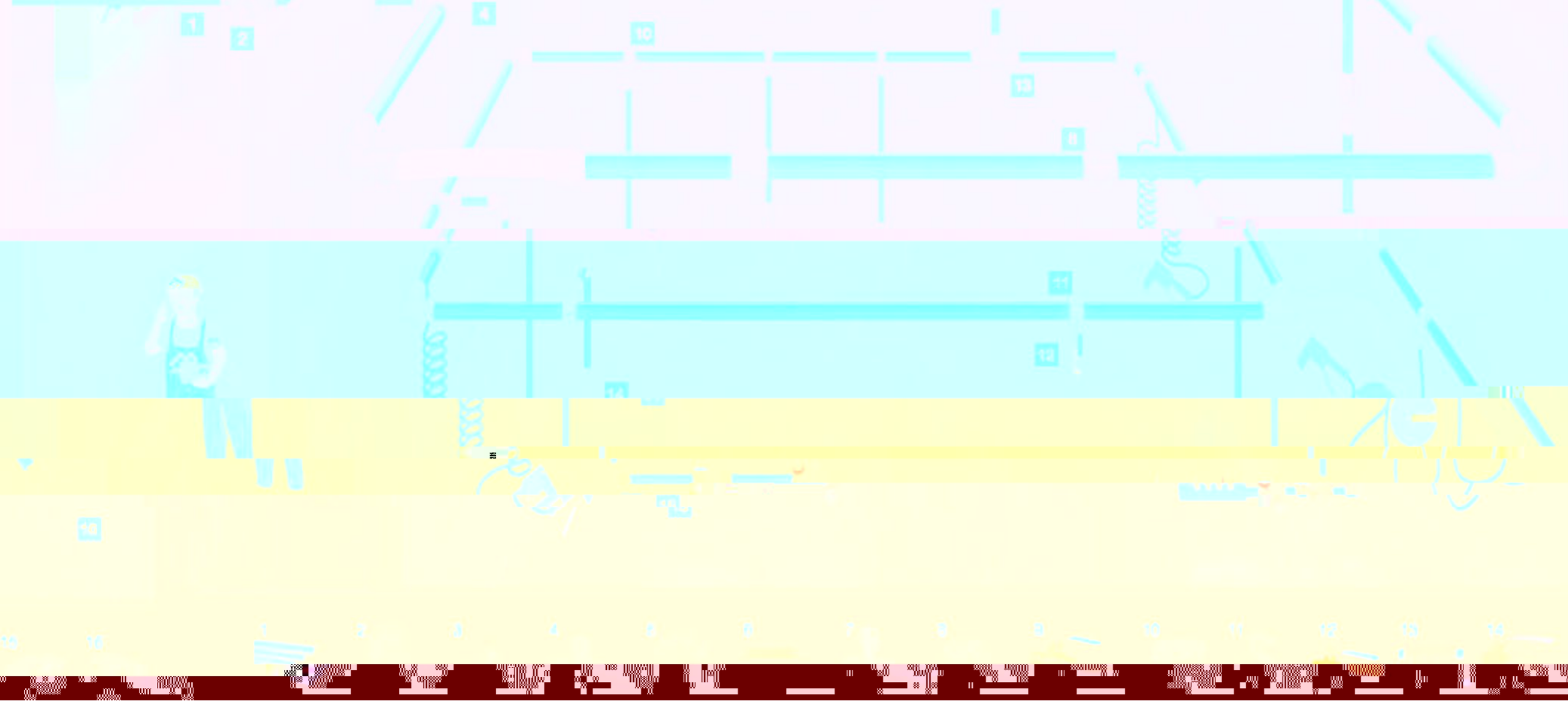

- |   |                |   |   |
|---|----------------|---|---|
| 1 | 5 <sup>F</sup> | 5 | 5 |
| 2 | 6 <sup>F</sup> | 6 | 6 |
| 3 | 7 <sup>F</sup> | 7 | 7 |
| 4 | 8 <sup>F</sup> | 8 | 8 |

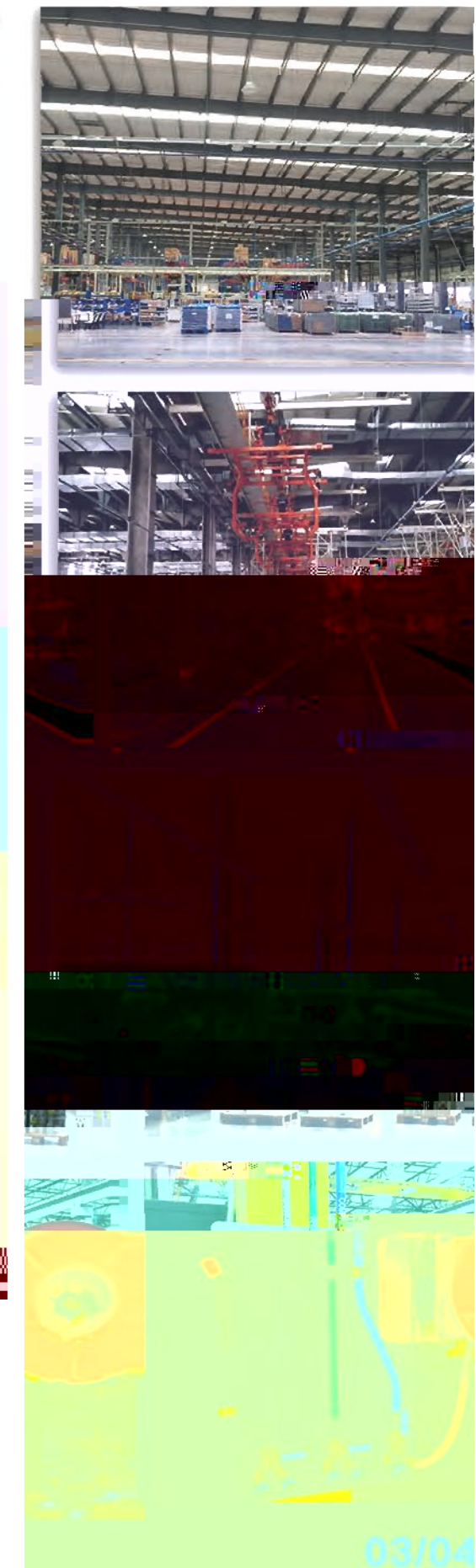





**FIXTURE CLAMPS & ACCESSORIES**  
管夾



\_\_\_\_\_

\_\_\_\_\_

\_\_\_\_\_

\_\_\_\_\_



\_\_\_\_\_

\_\_\_\_\_

\_\_\_\_\_

\_\_\_\_\_

**CLAMP SPACER**  
管夾墊



\_\_\_\_\_

\_\_\_\_\_

\_\_\_\_\_

\_\_\_\_\_

**VORTEX FLOW METER**  
渦街流量計



\_\_\_\_\_

\_\_\_\_\_

\_\_\_\_\_

\_\_\_\_\_

**THREADED ADAPTORS**  
轉接頭



\_\_\_\_\_

\_\_\_\_\_

\_\_\_\_\_

\_\_\_\_\_



\_\_\_\_\_

\_\_\_\_\_

\_\_\_\_\_

\_\_\_\_\_

**PRESSURE METER**  
氣體壓力錶



\_\_\_\_\_

\_\_\_\_\_

\_\_\_\_\_

\_\_\_\_\_

**ATMOLYSIS BAG**  
分子篩



\_\_\_\_\_

\_\_\_\_\_

\_\_\_\_\_

\_\_\_\_\_



**DRILL HOLDER**  
鑽頭夾具



**MARKER**  
記號器



**HOLE DEBURRER**  
去毛刺器

**ALUMINUM PIPE DEBURRER**  
鋁管去毛刺器



**SPANNERS**  
水泵鉗



**ALUMINUM PIPE CUTTER**  
鋁管切割器



**ELECTRIC PIPE CUTTER**  
電動鋁管切割機



**FIXING BOLTS**  
螺栓



**SQUARE STEEL**  
方鋼



**ADJUSTABLE BRACKET**  
可伸縮支架



**GRIDER CLAMP**  
老虎鉗



**SQUARE STEEL CLAMP**  
壓板



**PIPE BENDING**



**WALL MOUNTED BRACKET**  
懸臂支架



**UNIVERSAL BEAM SUSPENDER**  
外向抱箍吊扣



**FIXTURE CLAMPS & ACCESSORIES**  
萬向抱箍



**WIRE SUSPENSION CABLE**  
鋼絲繩



**WIRE STUDS**  
鋼絲掛架



**SELF-TAP SCREWS**  
螺絲



**PIPE BENDING MACHINE**



# Superior Reliability!

最佳可靠性



Insertion Depth S For DN20-DN50 Connector  
DN20-DN50 (3/4" - 2") 管路安裝插入深度S

DN	Insertion depth S (mm)	插入深度S (mm)
50		39

•	50	39
•		

## Installation Guide for DN20~DN50 安裝指導DN20-DN50 (3/4" - 2")

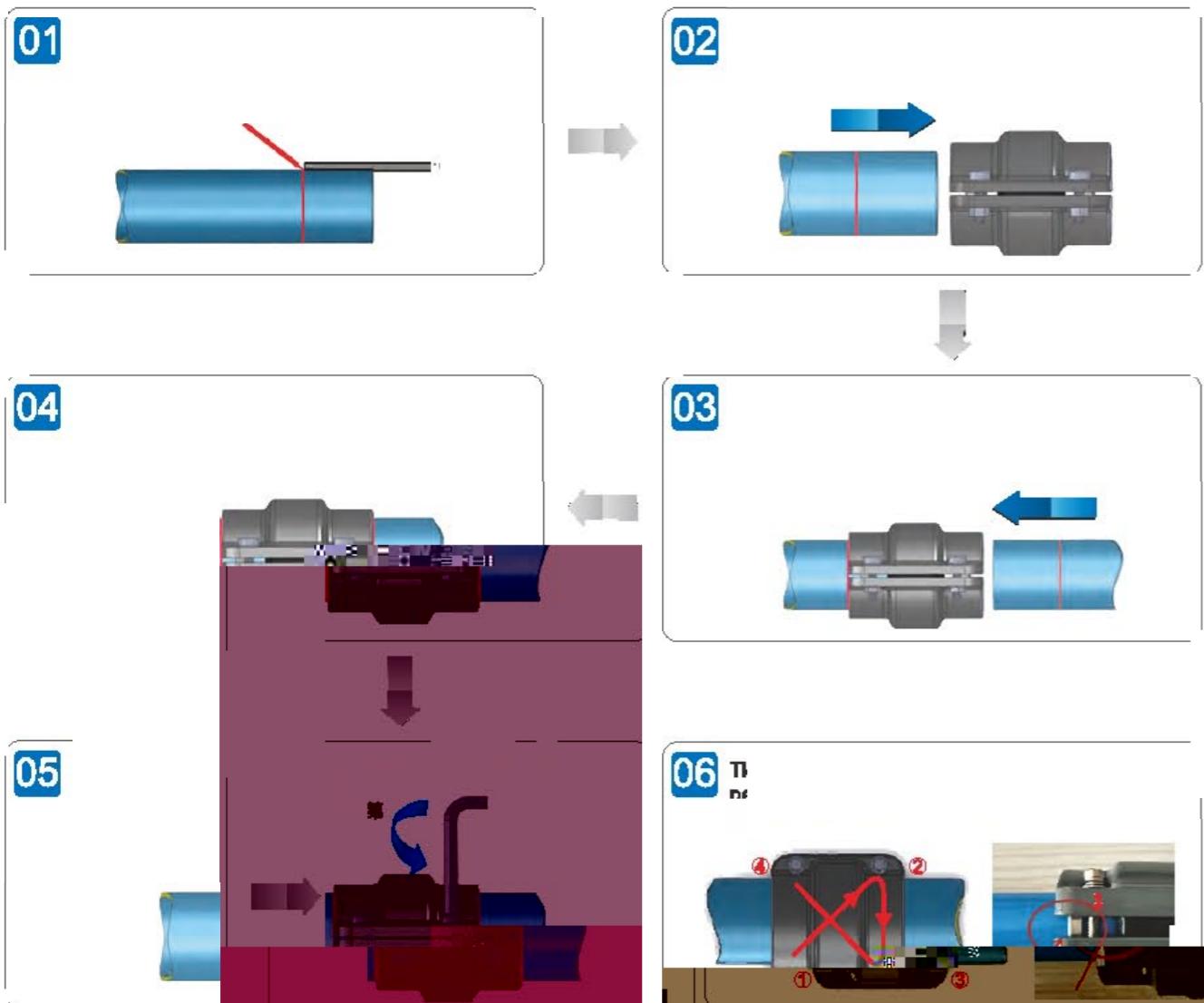

Deburr & Chamfer The Outer and Inner Edges Before Installation  
安裝前去除管端切口內外的毛邊

- 
- 

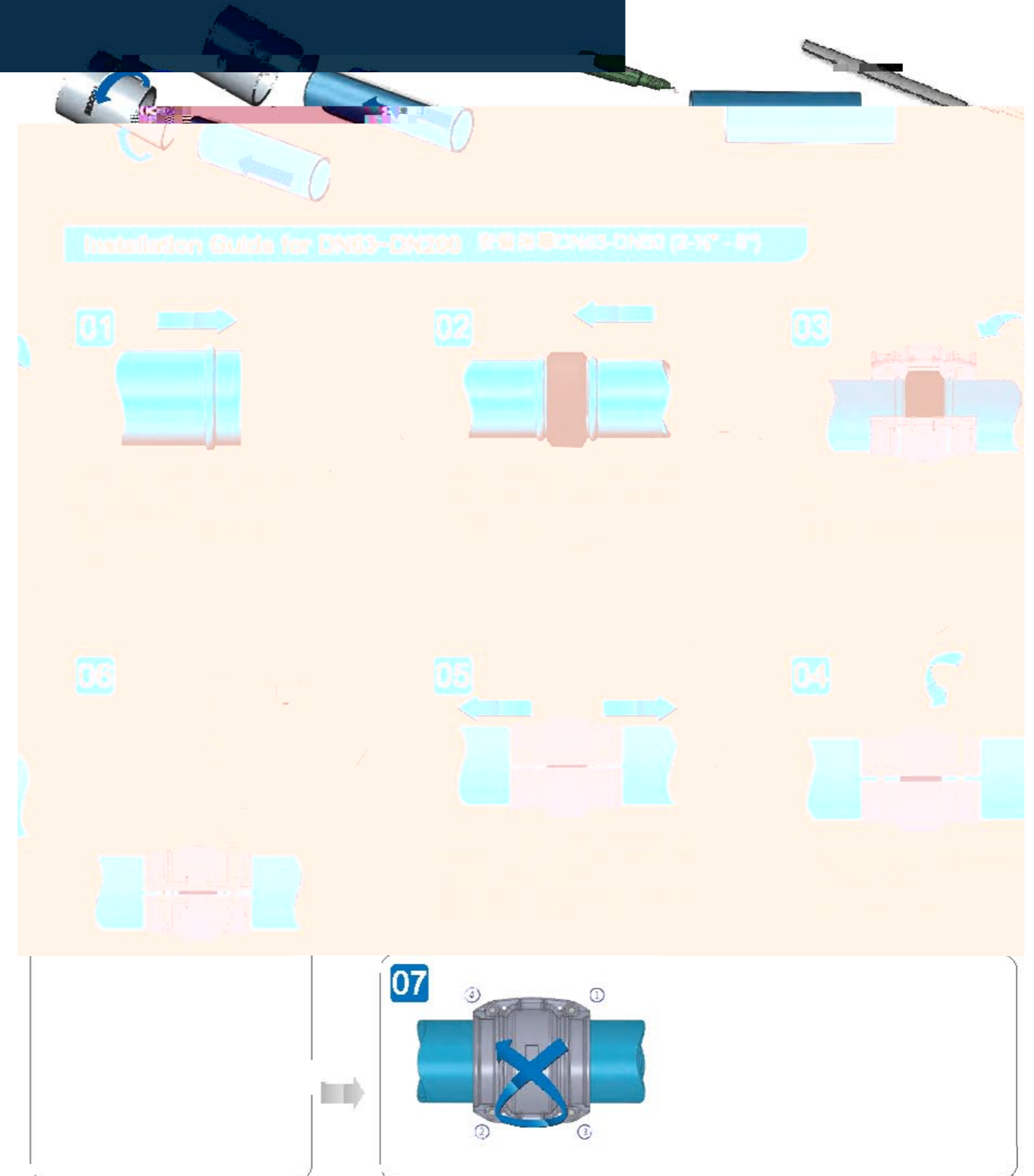

**Hand-held hydraulic lugging machine operation requirements 手持液壓凸管器作業要求**

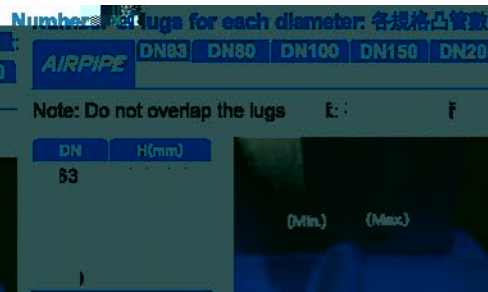
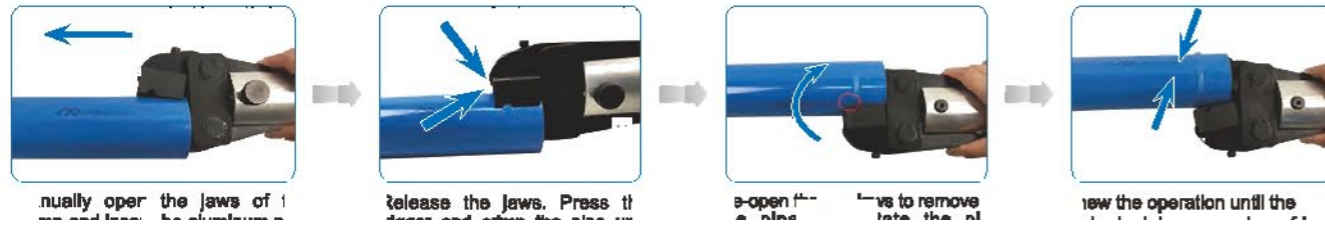

**Sizing Chart for Quick Drops 快換尺寸表**

Dr (mm)	Dr (Inch)	DN (MM)	Quick Drops (PN)	快換 (PN)
301.35	0005.01	301.35	0005.01	
11.35	0005.02	301.35	0006.05	Φ61
		302.10	1004.01	
		302.10	1005.01	
		302.10	1104.01	
		302.10	1106.01	

Flow 管流速度 N m <sup>3</sup> /h	50M	100M	150M	200M	300M	500M	750M	1000M	1500M	2000M
20	20	20	20	20	20	20	20	20	20	20
30	30	30	30	30	30	30	30	30	30	30
40	40	40	40	40	40	40	40	40	40	40
50	50	50	50	50	50	50	50	50	50	50
60	60	60	60	60	60	60	60	60	60	60
70	70	70	70	70	70	70	70	70	70	70
80	80	80	80	80	80	80	80	80	80	80
90	90	90	90	90	90	90	90	90	90	90
100	100	100	100	100	100	100	100	100	100	100
120	120	120	120	120	120	120	120	120	120	120
150	150	150	150	150	150	150	150	150	150	150
200	200	200	200	200	200	200	200	200	200	200
300	300	300	300	300	300	300	300	300	300	300
500	500	500	500	500	500	500	500	500	500	500
750	750	750	750	750	750	750	750	750	750	750
1000	1000	1000	1000	1000	1000	1000	1000	1000	1000	1000
1500	1500	1500	1500	1500	1500	1500	1500	1500	1500	1500
2000	2000	2000	2000	2000	2000	2000	2000	2000	2000	2000

**Technical Specifications 工況範圍**

- 適用
- 壓力
- 溫度
- 規格

**Qualification & Standards 符合規範和標準**

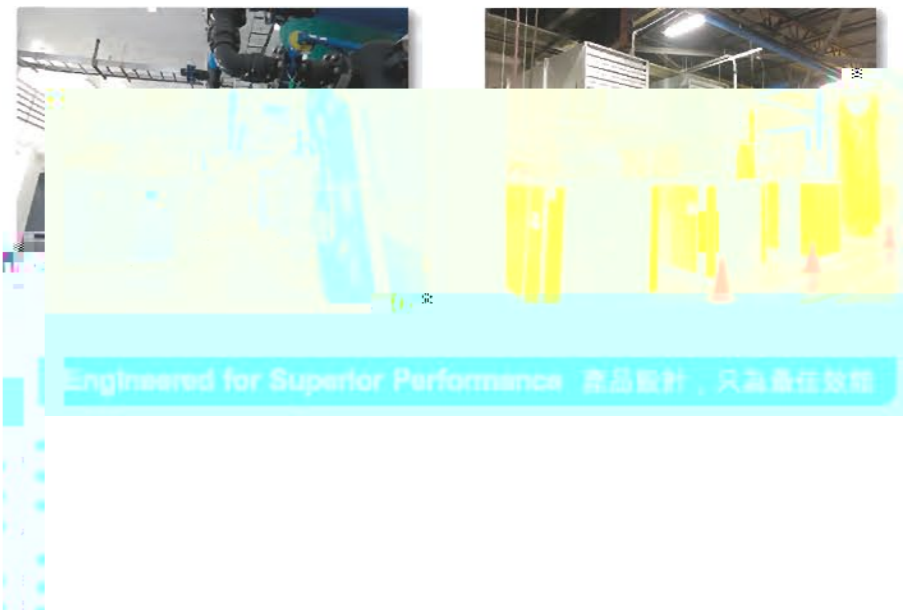

we are at your **SERVICE**  
我們始終在您的身邊

